



COLT CANADA LAW ENFORCEMENT PATROL CARBINE

CARBINE, 5.56MM SEMI-AUTOMATIC, IUR-LE PATROL AMBIDEXTRIOUS

94202C-1EV

- 1 » ENTIRE ASSEMBLY AS ILLUSTRATED
- 13 » 14 - 23
- 24 » 25 - 28
- 29 » 30 - 33
- 34 » 35 - 45
- 42 » 43 - 44
- 46 » 47 - 87
- 68 » 69 - 72

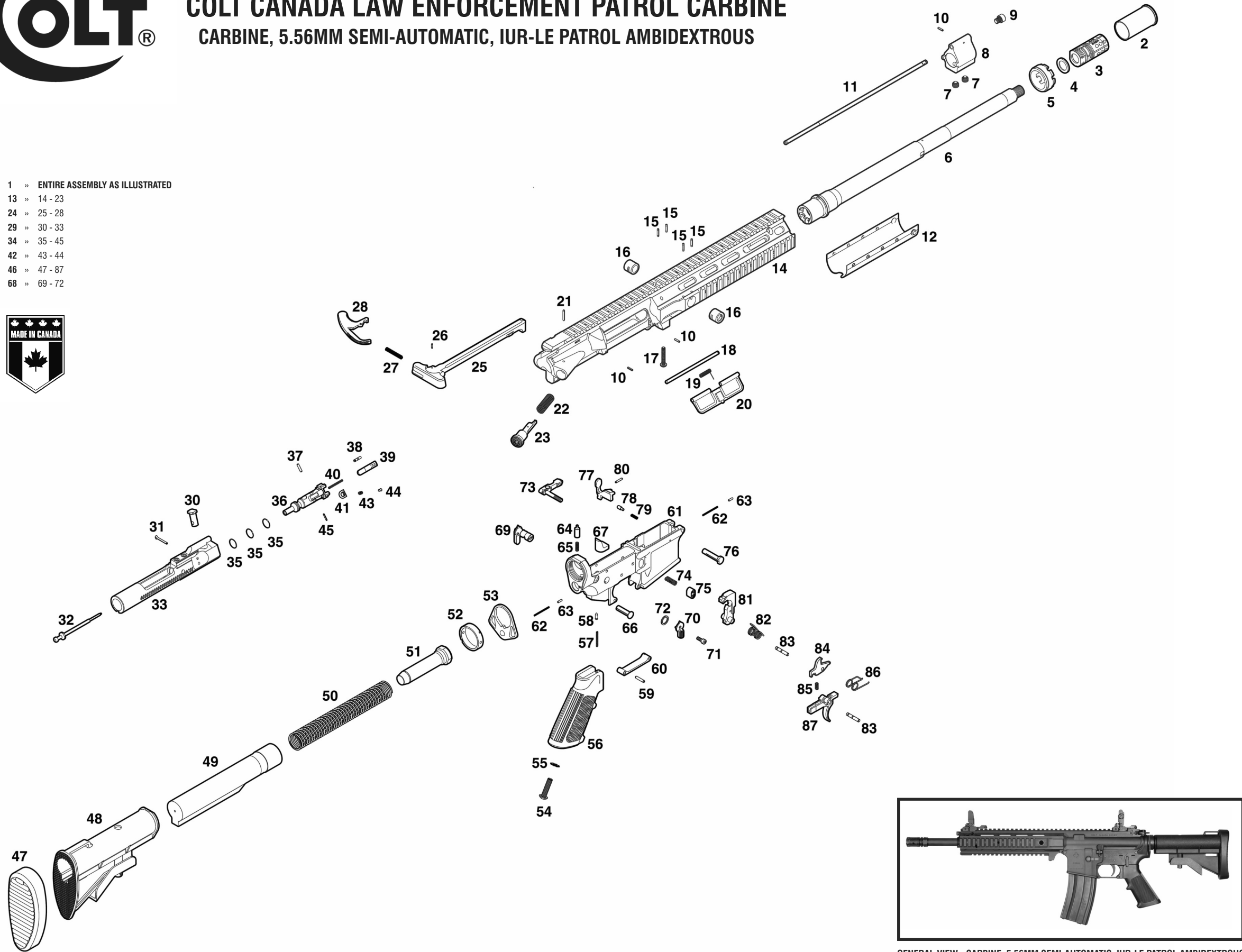

GENERAL VIEW - CARBINE, 5.56MM SEMI-AUTOMATIC, IUR-LE PATROL AMBIDEXTRIOUS

ITEM	PART NO.	DESCRIPTION
1	94202C-1	CARBINE, 5.56MM SEMI, IUR-LE PATROL AMBIDEXTRIOUS
2	07500C-1	CAP, MUZZLE (BLACK)
3	0376235-1	COMPENSATOR, C9A2
4	09126C-1	WASHER, COMPENSATOR, CONSTANT TORQUE
5	13074C-1	NUT, BARREL
6	14674C-1	BARREL ASSEMBLY, HEAVY, CARBINE - 14.5"
7	15244C-1	SCREW, SET, HEX - .3125-24 x .250 LG
8	15282C-1	BLOCK, GAS
9	15285C-1	SCREW, CAP, SOCKET HEAD - .250 - 28 x .250
10	CF95108	PIN, ROLL
11	13362C-1	GAS TUBE AND PLUG ASSEMBLY
12	13482C-1	HEATSHIELD ASSEMBLY
13	15310C-1	UPPER REC ASSEMBLY, EXTENDED - NATO
14	15331C-1	RECEIVER SUB-ASSEMBLY, IUR
15	10209C-1	PIN, COILED, SPRNG TEN 3/32 x 7/16
16	15311C-1	INSERT, SLING SWIVEL
17	13359C-1	SCREW, CAP, BUTTON HEAD - .164-32 x 1.00
18	13097C-1	PIN, COVER HINGE
19	CF61518	SPRING, COVER
20	CF64532	EJECTION PORT COVER ASSEMBLY
21	CF95126	PIN, ROLL
22	CF62271	SPRING, PLUNGER
23	CF64529	FORWARD ASSIST ASSEMBLY
24	9978334-1	CHARGING HANDLE ASSEMBLY, AMBIDEXTRIOUS
25	CF62288	HANDLE, CHARGING
26	0376396-1	PIN, SOLID DOWEL, .0625 x .25 LG
27	CF61875	SPRING, CHARGING HANDLE LATCH
28	12075C-1	LATCH, TACTICAL, CHARGING HANDLE
29	11486C-2	BOLT CARRIER ASSEMBLY, SEMI-AUTOMATIC
30	CF61704	PIN, CAM
31	CF62335	PIN, RETAINING, FIRING PIN
32	CF62294	PIN, FIRING
33	11487C-1	KEY AND BOLT CARRIER ASSEMBLY
34	07731C-2	BOLT ASSEMBLY
35	CF61540	RING, BOLT
36	CF61538	BOLT
37	CF61563	PIN, EXTRACTOR
38	CF61564	EJECTOR
39	CF61562	EXTRACTOR
40	03488C-1	SPRING, EJECTOR & SAFETY DETENT
41	09048C-1	INSERT, ELASTOMERIC-EXTRACTOR
42	10147C-1	SPRING ASSEMBLY, EXTRACTOR
43	10171C-1	SPRING, EXTRACTOR
44	10148C-1	INSERT, EXTRACTOR (BLACK)
45	CF95102	PIN, ROLL
46	90026C-1	LOWER REC & BUTTSTOCK ASSEMBLY, SEMI - AUTOMATIC
47	10475C-1	SHOULDER PAD, BUTTSTOCK (BLACK)
48	CF64822	SLIDING BUTTSTOCK ASSEMBLY
49	07922C-5	EXTENSION, RECEIVER (6 POS)
50	CF62373	SPRING, ACTION
51	08562C-4	BUFFER ASSEMBLY - HHH
52	CF62357	NUT, RECEIVER EXTENSION
53	09957C-1	PLATE ASSEMBLY W/DOUBLE SLING LOOP
54	MS51958-83	SCREW, MACHINE, PAN HEAD
55	CF90001	WASHER, LOCK [MS35335-61]
56	07869C-1	HANDGRIP ASSEMBLY (BLACK)
57	CF61569	SPRING, EJECTOR & SAFETY DETENT
58	CF61785	DETENT, FIRE CONTROL SELECTOR
59	CF95106	PIN, ROLL
60	CF61970	TRIGGER GUARD ASSEMBLY
61	11485C-1	RECEIVER, LOWER-SEMI-AUTOMATIC
62	CF61692	SPRING, DETENT, TAKEDOWN PIN
63	CF61698	DETENT, TAKEDOWN PIN
64	CF61582	RETAINER, BUFFER
65	CF61694	SPRING, BUFFER RETAINER
66	CF61655	PIN, TAKEDOWN
67	09728C-2	SPRING, ELASTOMERIC, RECEIVER
68	11459C-3	SELECTOR GROUP, FIRE CONTROL, AMBIDEXTRIOUS
69	12067C-1	HANDLE, SELECTOR, AMBIDEXTRIOUS
70	10144C-1	SELECTOR, FIRE CONTROL, AMBIDEXTRIOUS, SEMI-AUTOMATIC
71	10196C-1	SCREW, RETAINING, SELECTOR
72	15649C-1	WASHER, SELECTOR
73	11495C-1	CATCH ASSEMBLY, MAGAZINE, AMBIDEXTRIOUS
74	CF61759	SPRING, MAGAZINE CATCH
75	CF62032	BUTTON, MAGAZINE RELEASE
76	CF62221	PIN, RECEIVER PIVOT
77	CF62301	CATCH, BOLT
78	CF62178	PLUNGER, BOLT CATCH
79	CF62177	SPRING, BOLT CATCH
80	CF95105	PIN, ROLL
81	11481C-1	HAMMER & HAMMER PIN RETAINER ASSEMBLY, SEMI-AUTOMATIC
82	CF61697	SPRING, HAMMER
83	CF61654	PIN, HAMMER & TRIGGER
84	11483C-1	DISCONNECT, SEMI-AUTOMATIC
85	07992C-1	SPRING, DISCONNECT (BLACK)
86	CF61657	SPRING, TRIGGER
87	CF61955	TRIGGER